



INTAKE SYSTEMS FOR VEHICLES LISTED ARE 50 STATE LEGAL. SEE KNFILTERS.COM FOR CARB STATUS ON EACH PART FOR A SPECIFIC VEHICLE.

## INSTALLATION INSTRUCTIONS

# 71-3066

## CHEVROLET / GMC

### 2007-10 Silverado 2500 HD / 3500 HD

### 2007-10 Sierra 2500 HD / 3500 HD

### V8-6.6L Turbo Diesel

#### TOOLS NEEDED:

- ratchet extension
- 10mm socket
- t20 torx
- flat blade screw driver
- 2.5mm allen key

NOTE: This kit was not designed to fit vehicles with a body lift.

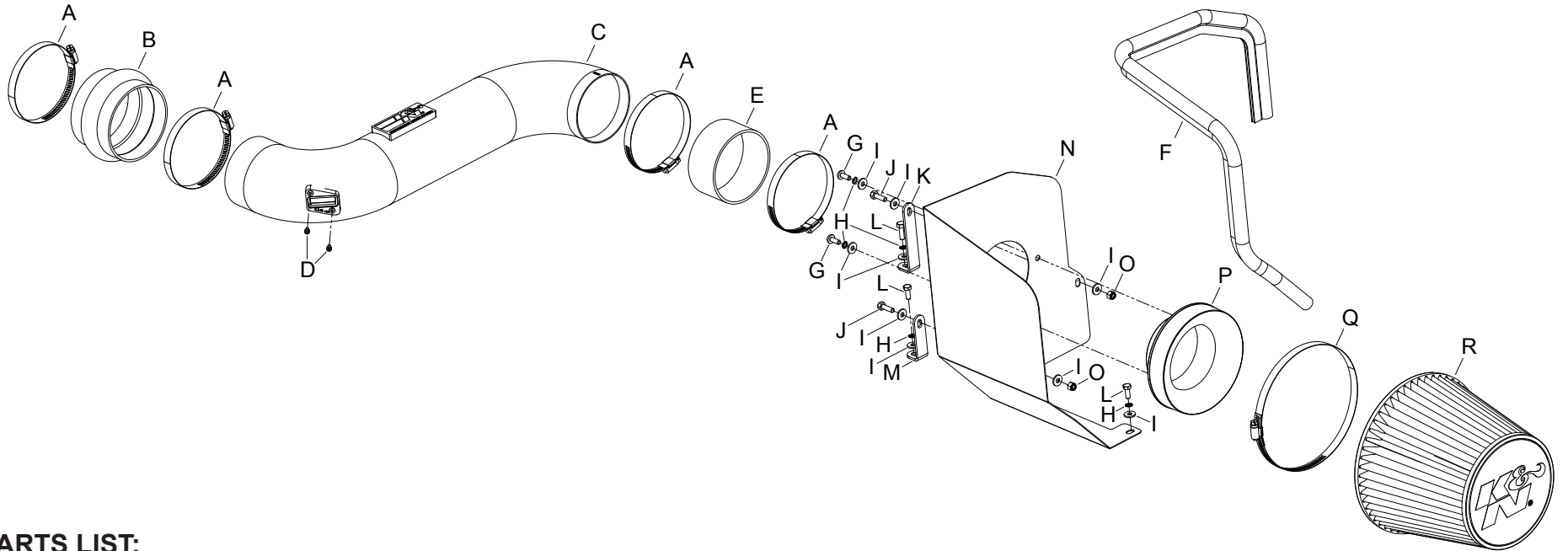

#### PARTS LIST:

Description	Qty.	Part #	Description	Qty.	Part #	Description	Qty.	Part #
A Hose Clamp #64, Black Zinc	4	08645K	G Bolt; M6 X 1.00 X 16MM , SS	2	07730	M Bracket; "L", TB/PC	1	07805
B Hose; 4-3/16"ID X 3"L Hump	1	08617	H Washer; M6 Split Lock Zinc	5	1-3025	N Heat shield	1	073120
C Intake Tube	1	27591TK	I Washer; 1/4"ID X 5/8"OD-SAE	9	08275	O Nut; 6MM Nylock, Hexhead, SS	2	07512
D Bolt; M4-0.07 8MM, A/H Cap, SS	2	07733	J Bolt; 6MM -1.00 X 16MM, SS	2	07812	P Adaptor; 57-3058 #454	1	27300
E Hose; 4"ID X 2"L Reinforced	1	08761	K Bracket; 57-3025, L-Bend, TB/PC	1	070952	Q Hose Clamp #104, Black Zinc	1	08697K
F Edge Trim (44")	1	102486	L Bolt; M6 X 1.00"X 20MM, Hex	3	07795	R Air Filter	1	RU-5177HBK

**NOTE: FAILURE TO FOLLOW INSTALLATION INSTRUCTIONS AND NOT USING THE PROVIDED HARDWARE MAY DAMAGE THE INTAKE TUBE, THROTTLE BODY AND ENGINE.**

#### TO START:

1. Turn off the ignition and disconnect the negative battery cable.

**NOTE: Disconnecting the negative battery cable erases pre-programmed electronic memories. Write down all memory settings before disconnecting the negative battery cable. Some radios will require an anti-theft code to be entered after the battery is reconnected. The anti-theft code is typically supplied with your owner's manual. In the event your vehicles' anti-theft code cannot be recovered, contact an authorized dealership to obtain your vehicles anti-theft code.**

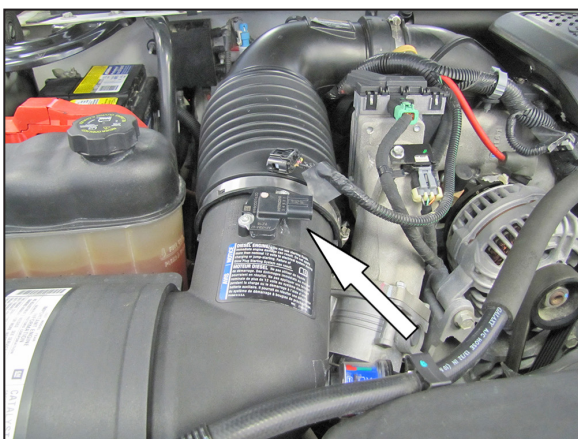

2. Disconnect the mass air sensor electrical connection.

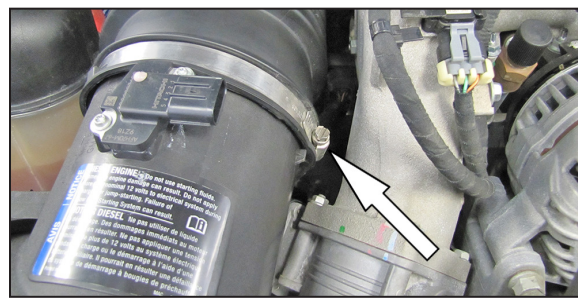

3. Loosen the hose clamp securing the factory intake tube to the air box.



4. Loosen the hose clamp securing the intake tube to the turbo inlet and then remove the intake tube from the vehicle.



5. Lift up and remove the air filter assembly from the vehicle.

**NOTE: K&N Engineering, Inc., recommends that customers do not discard factory air intake.**

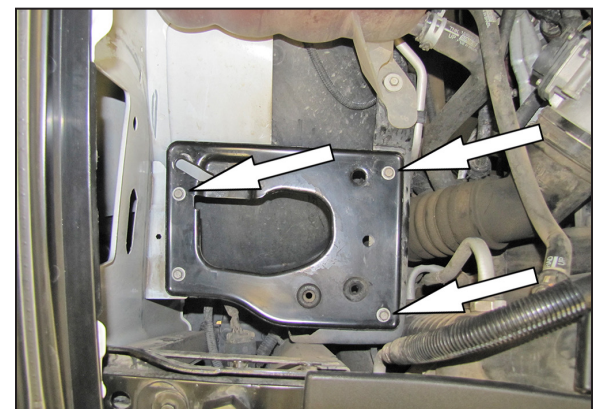

6. Remove the three bolts shown securing the air filter mounting plate.  
**NOTE: These bolts will be reused in a later step.**

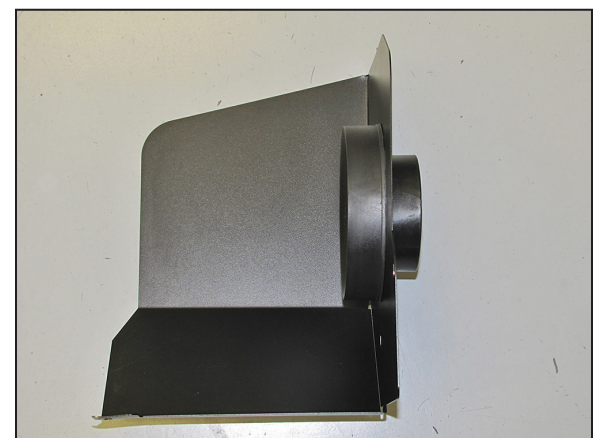

7. Install the filter adapter into the heat shield and secure with the provided hardware.

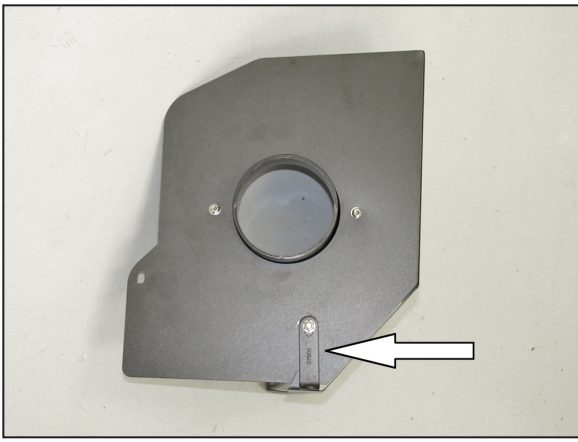

8. Install the provided heat shield bracket (07805) onto the heat shield and secure with the provided hardware.

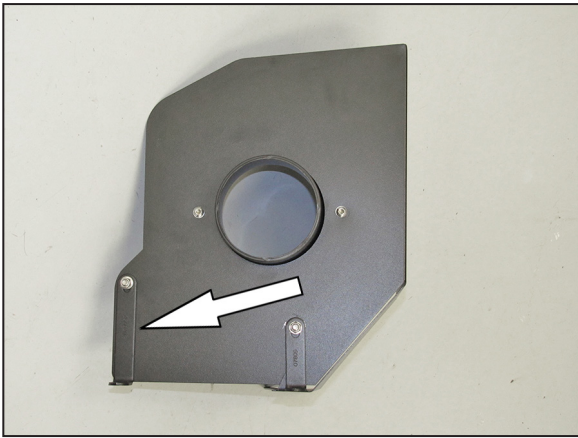

9. Install the provided heat shield bracket (070952) onto the heat shield and secure with the provided hardware.

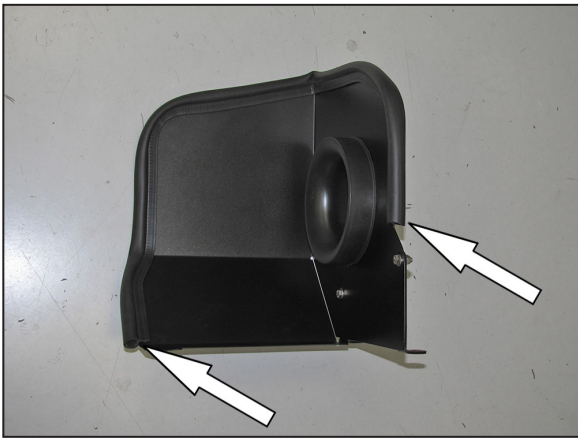

10. Install the provided edge trim onto the heat shield as shown.

**NOTE: Some trimming of the edge trim will be necessary.**



11. Install the heat shield assembly onto the filter mounting plate and secure with factory bolts from step #5.



12. Install the K&N® air filter onto the filter adapter and secure with the provided hose clamp.

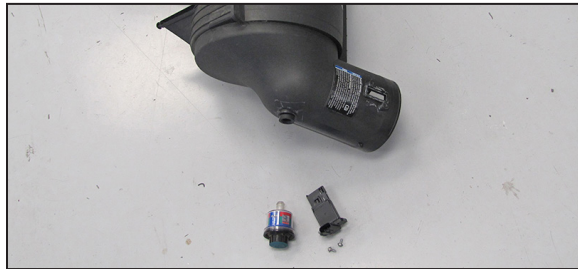

13. Remove the two screws securing the mass air sensor into the factory air box, and then remove the sensor. Remove the filter minder from the factory air box.



14. Install the mass air sensor and filter minder into the K&N® intake tube using the provided hardware and grommet.

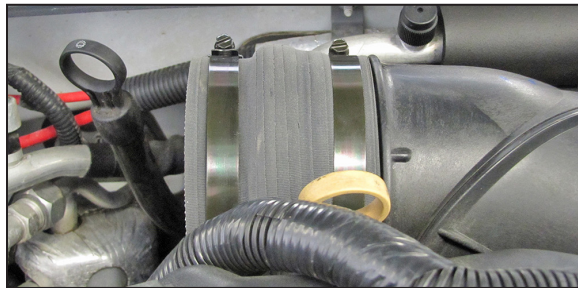

15. Install the provided hump hose (08633) onto the turbo inlet and secure with the provided hose clamp.

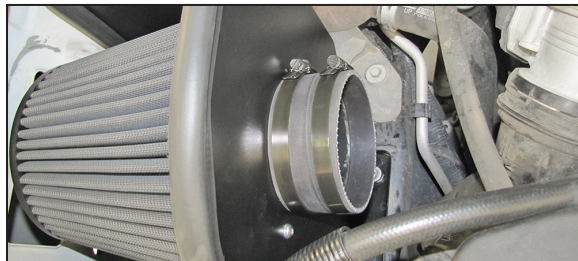

16. Install the provided coupling hose (08761) onto the filter adapter and secure with the provided hose clamp.

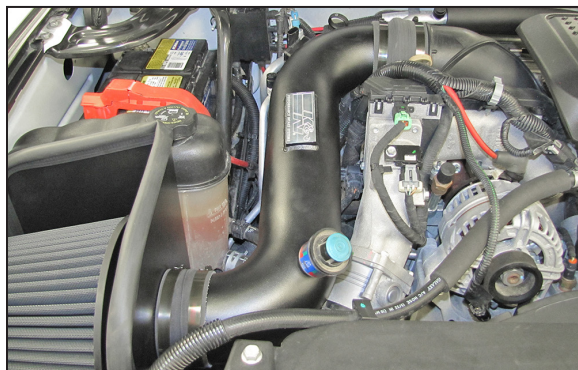

17. Install the K&N® intake tube into the hump hose at the turbo inlet and then into the hose at the filter adapter. Align the tube for best fit and then secure with the provided hose clamps.

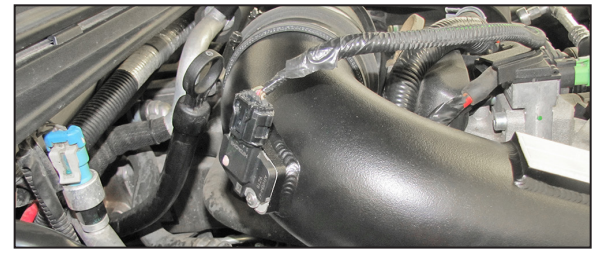

18. Connect the mass air sensor electrical connection.

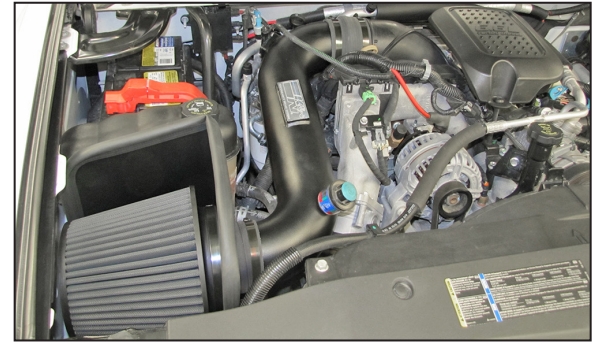

19. Reconnect the vehicle's negative battery cable. Double check to make sure everything is tight and properly positioned before starting the vehicle.

20. The C.A.R.B. exemption sticker, (attached), must be visible under the hood so that an emissions inspector can see it when the vehicle is required to be tested for emissions. California requires testing every two years, other states may vary.

21. **NOTE:** Most General Motors vehicles have the Vehicle Emissions Certification Information (VECI) label affixed to the air filter box. In order to be compliant with California emissions laws, the label **MUST** remain in the engine compartment. If the Vehicle Emission Control Information label is removed during modification, a new replacement label must be obtained and installed in a readily visible position in the engine compartment. The label shall not be affixed to any equipment which is easily detached from the vehicle. We recommend that the label is affixed to the underside of the hood adjacent to the hood latch. The label is Vehicle Identification Number dependent and can be ordered from the vehicle dealership. In order to receive the proper decal please bring your VIN with you. Failure to have the VECI under the hood may result in failure of a pre-registration smog test.

22. It will be necessary for all K&N® high flow intake systems to be checked periodically for realignment, clearance and tightening of all connections. Failure to follow the above instructions or proper maintenance may void warranty.

#### ROAD TESTING:

1. Start the engine with the transmission in neutral or park, and the parking brake engaged. Listen for air leaks or odd noises. For air leaks secure hoses and connections. For odd noises, find cause and repair before proceeding. This kit will function identically to the factory system except for being louder and much more responsive.

2. Test drive the vehicle. Listen for odd noises or rattles and fix as necessary.

3. If road test is fine, you can now enjoy the added power and performance from your kit.

4. K&N Engineering, Inc., requires cleaning the Blackhawk Induction™ intake system's air filter element every 100,000 miles. When used in dusty or off-road environments, our filters will require cleaning more often. We recommend that you visually inspect your filter once every 25,000 miles to determine if the screen is still visible. When the screen is no longer visible some place on the filter element, it is time to clean it. To clean, purchase our Synthetic Filter Cleaner, part number 99-0624 and follow the easy instructions.

**INTAKE SYSTEMS FOR VEHICLES LISTED ARE 50 STATE LEGAL. SEE KNFILTERS.COM FOR CARB STATUS ON EACH PART FOR A SPECIFIC VEHICLE.**